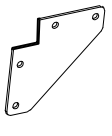
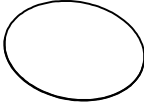
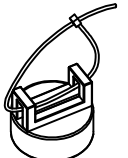

Ø5*12mm	Ø6*30mm	Ø12*0.8mm	
① x47	② x4	③ x4	④ x8
spare:2		spare:2	spare:2

		
62*62mm	Ø100*0.8mm	
⑤ x4	⑥ x2	⑦ x2

Hardware	Ctn No.	1
----------	---------	---

No.	Size	Qty
A	418x400x24mm	2
B	434x389.5x23mm	2
B1	429x389.5x23mm	1
B2	434x389.5x23mm	1
C1	371x423x20mm	2
C2	371x423x20mm	2
D	1801.5x402x38mm	1
E	1798.5x205x20mm	2
F	876x351x25mm	1
F1	460x351x25mm	1
F2	460x351x25mm	1
G1	460x350x20mm	2
G2	876x350x20mm	1
H	400x392.5x24mm	2

(1) - Attach (A) &(H) to (E) as below shown.

Make sure the holes face outward for correct door assembly.

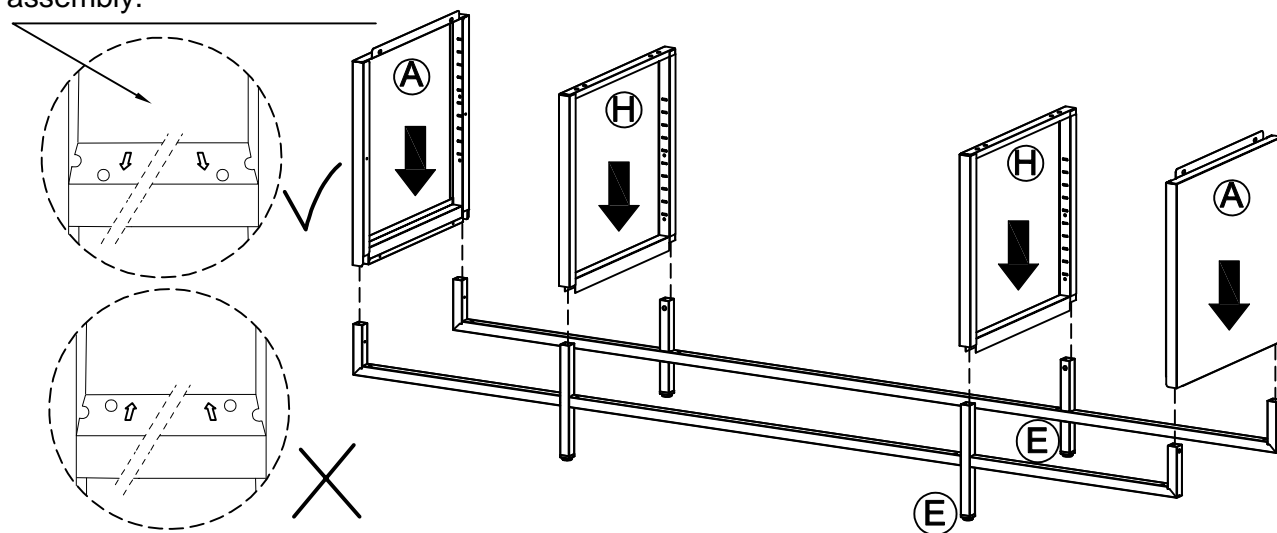

The plastic foot cover face down

(2) - Attach ⑤ to (A)&(E) as below shown.

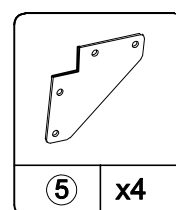
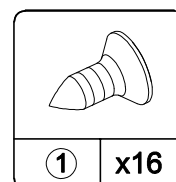
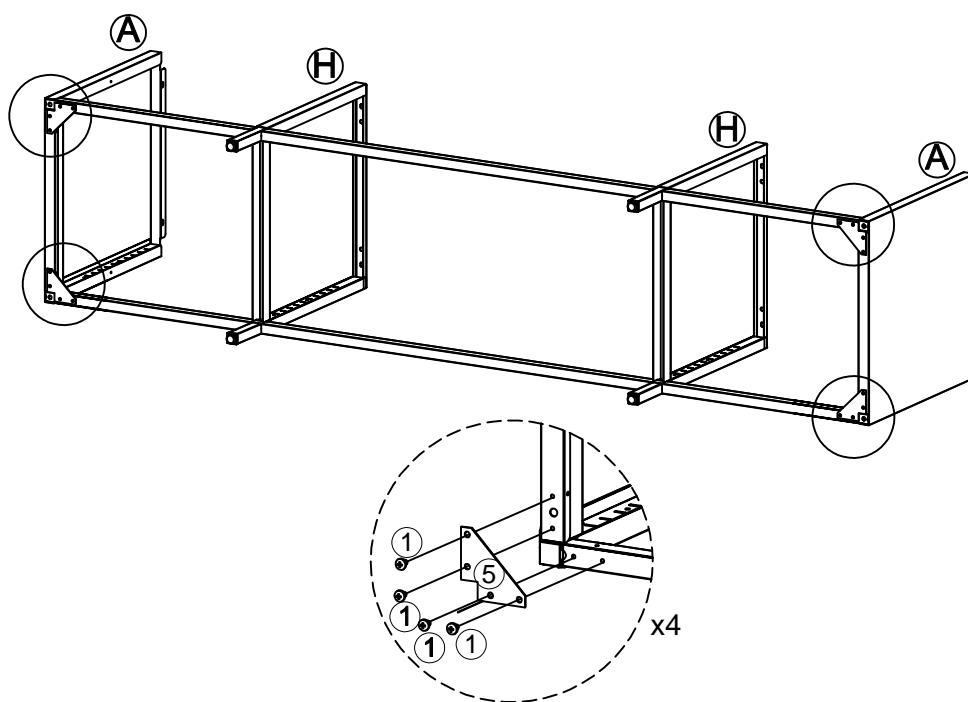

- (3) - Attach (B) & (B1) & (B2) to (A) & (H) as below shown.
 - Attach (6) & (7) to (B) as below shown.

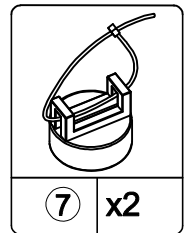
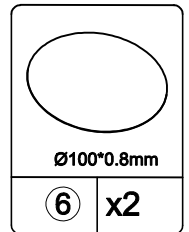
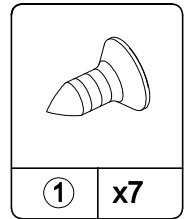
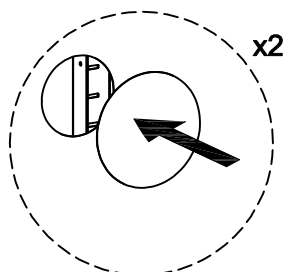
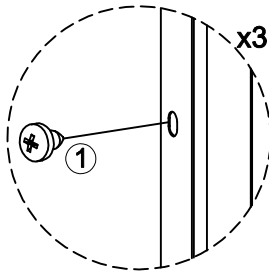
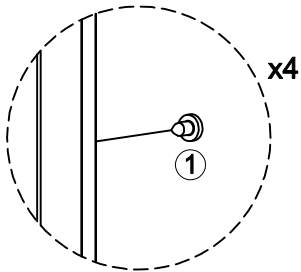
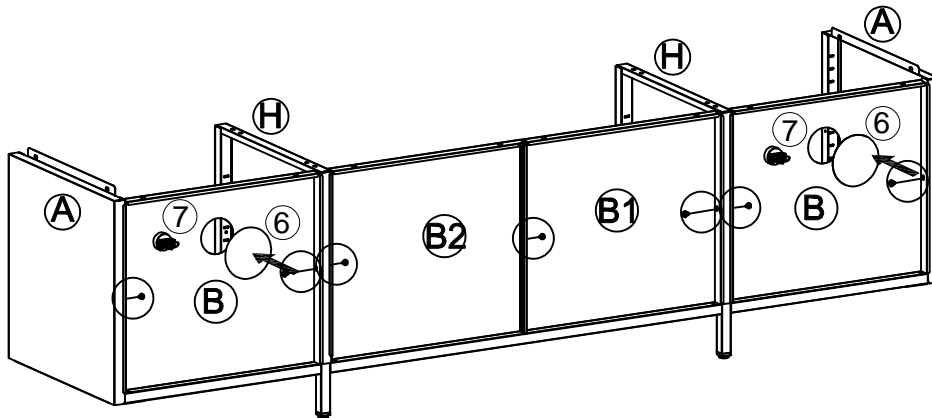

- (4) - Attach (B) & (B1) & (B2) to (E) as below shown.

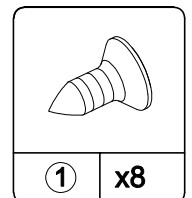
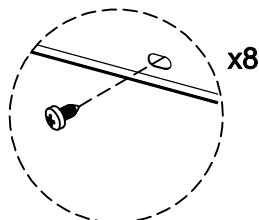
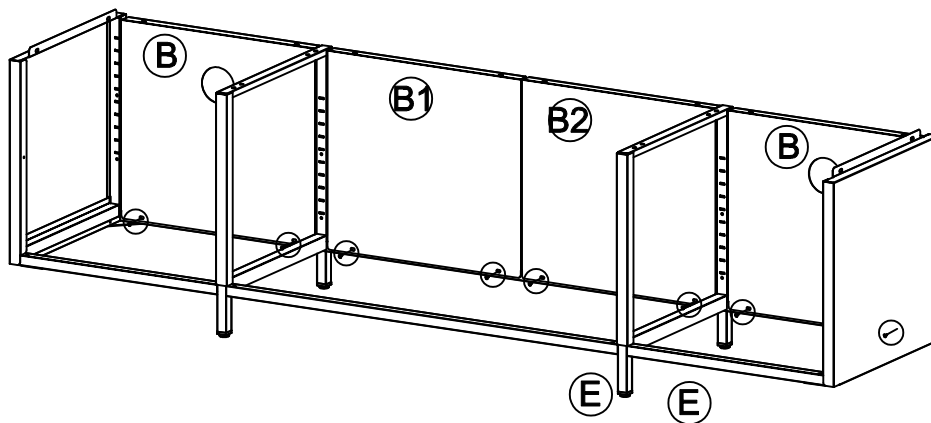

(5) - Attach (F) & (F1) & (F2) to (A) & (H) as below shown.

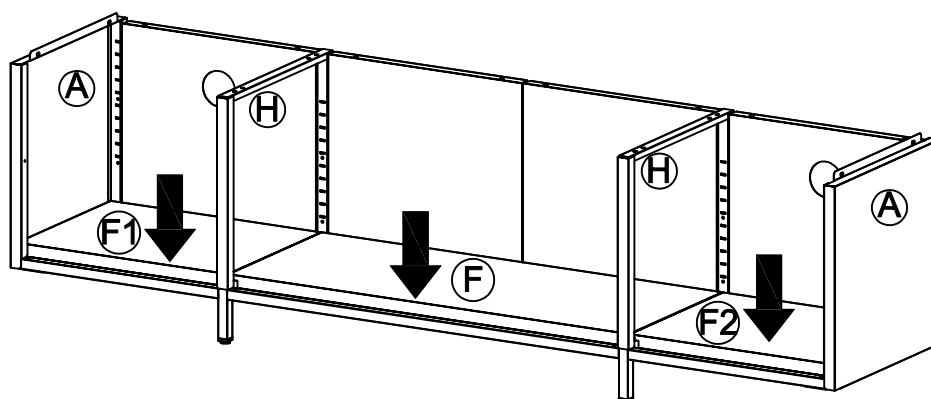

(6) - Attach (D) to (A) & (B)&(B1)&(B2)&(H) as below shown.

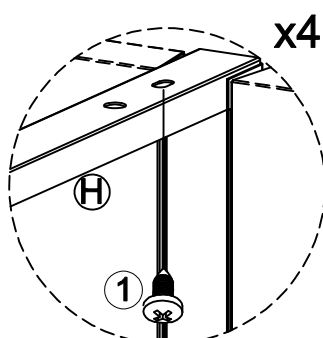
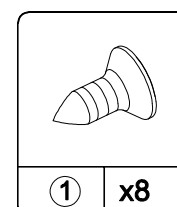
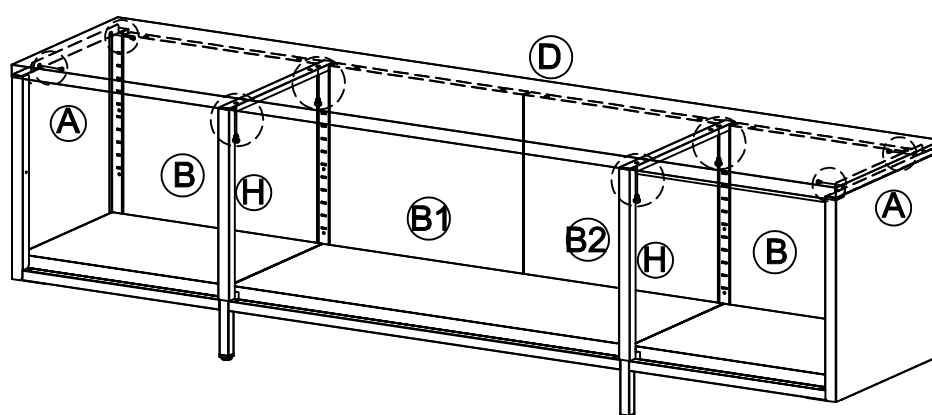

x4

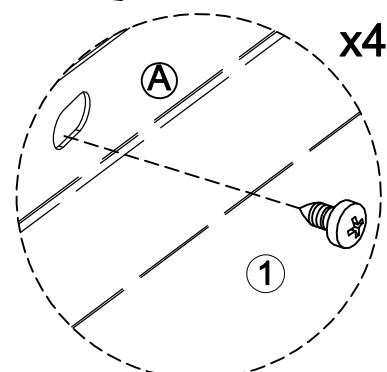

x4

(7) - Attach (B) & (B1) & (B2) to (D) as below shown.

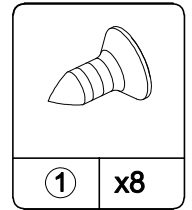
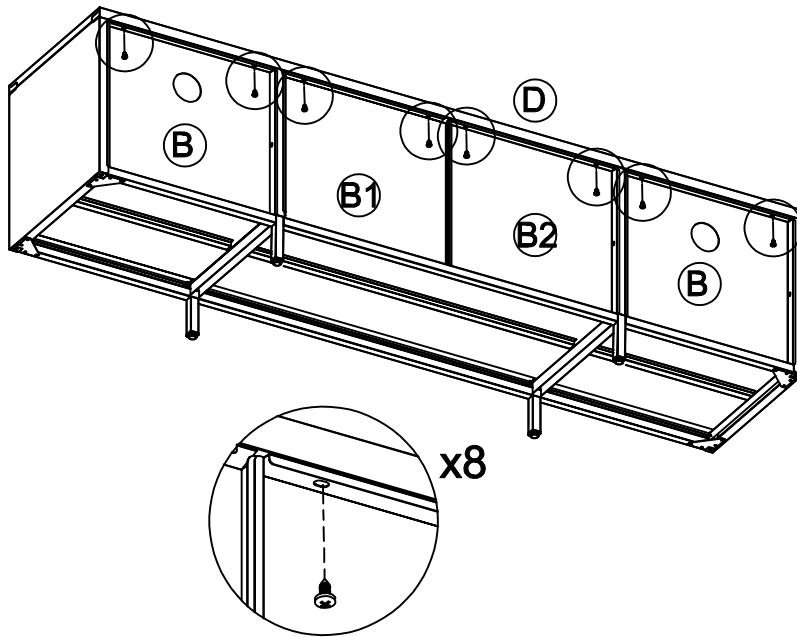

(8) - Attach (G1) & (G2) to pre-assembled unit as below shown.

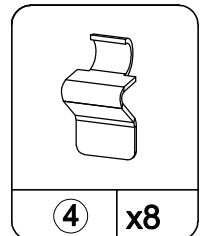
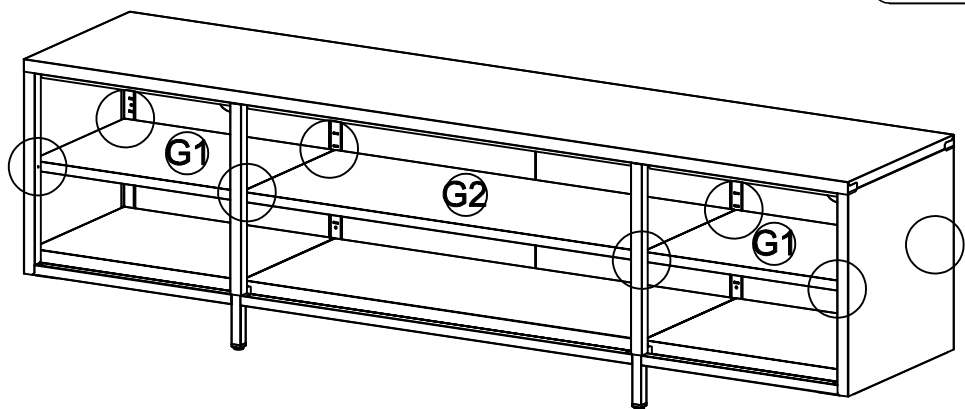
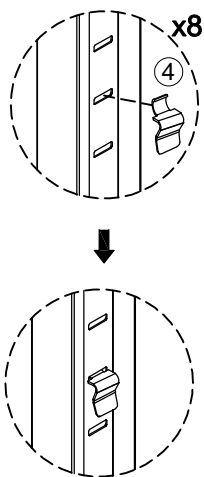

Shelves must be aligned at the same height to ensure secure placement.

(9) -Attach (2) & (3) to pre-assembled unit as below shown.

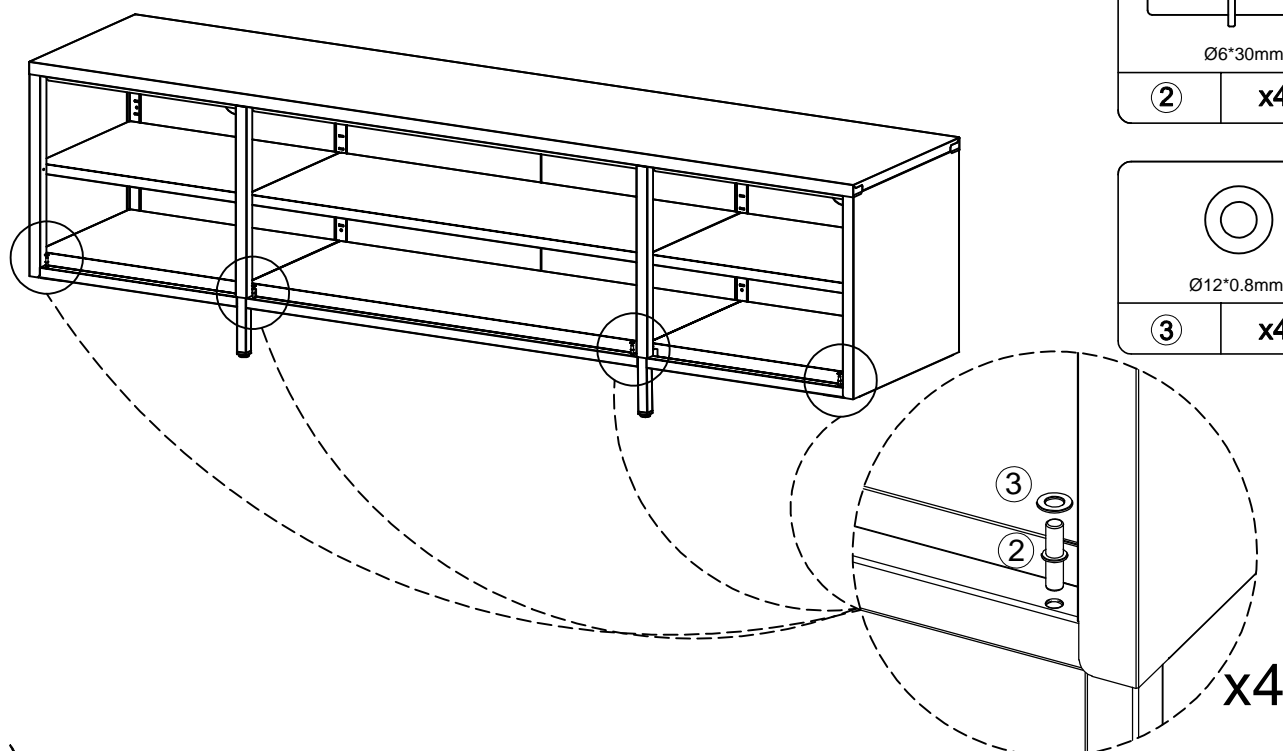

(10)- Attach (C1) & (C2) to pre-assembled unit as below shown.

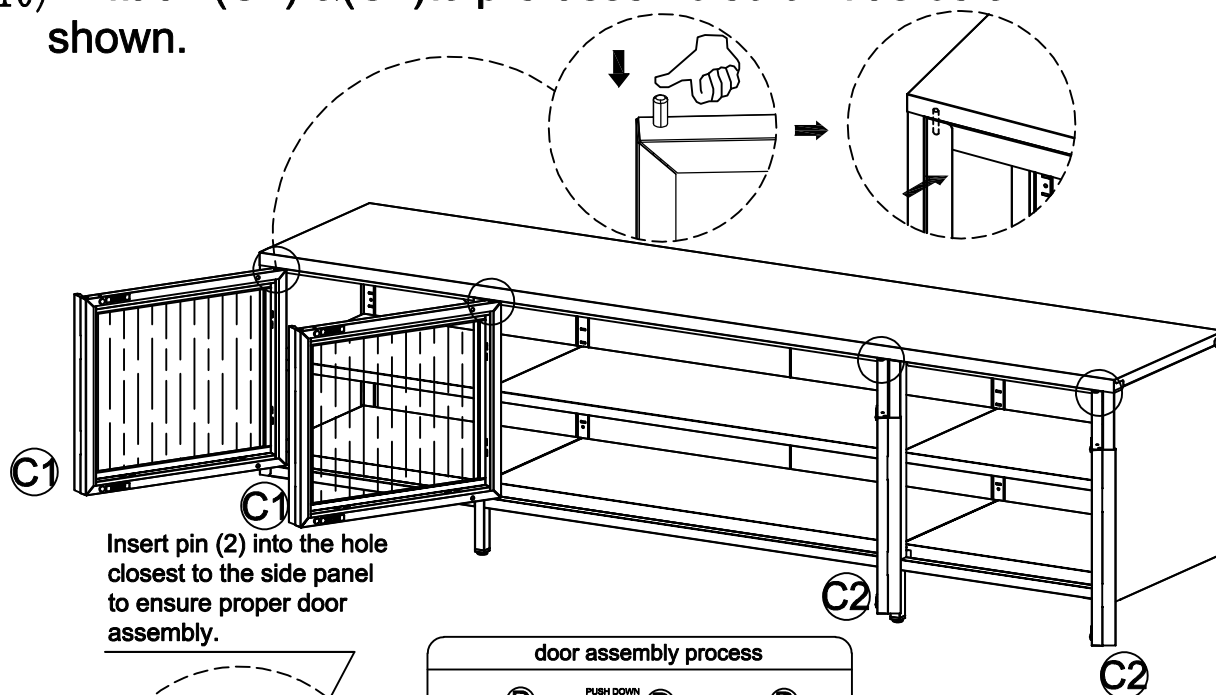

Insert pin (2) into the hole closest to the side panel to ensure proper door assembly.

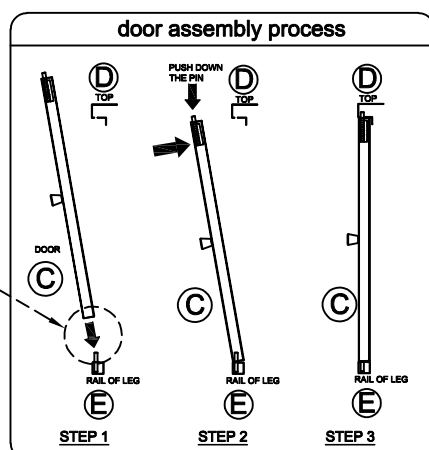
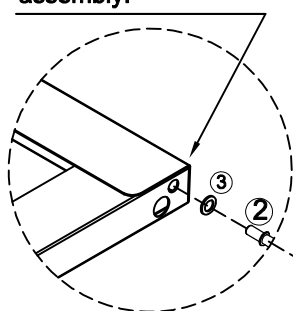

(11)

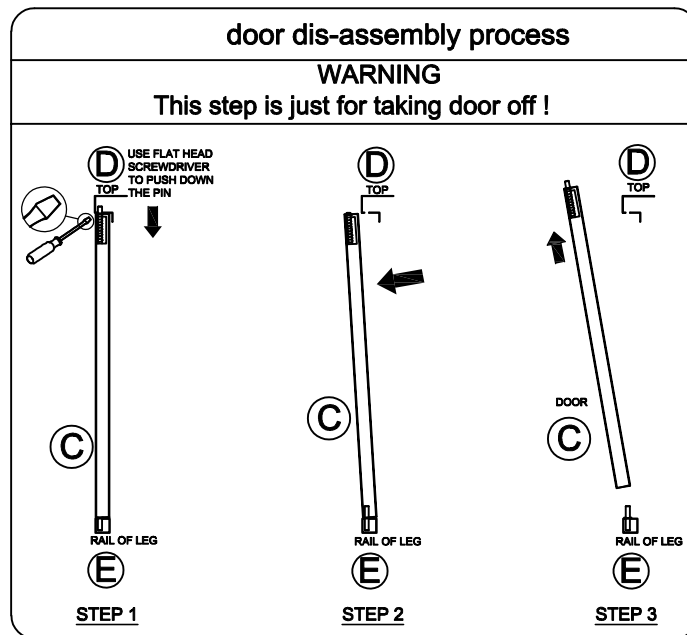

(12)

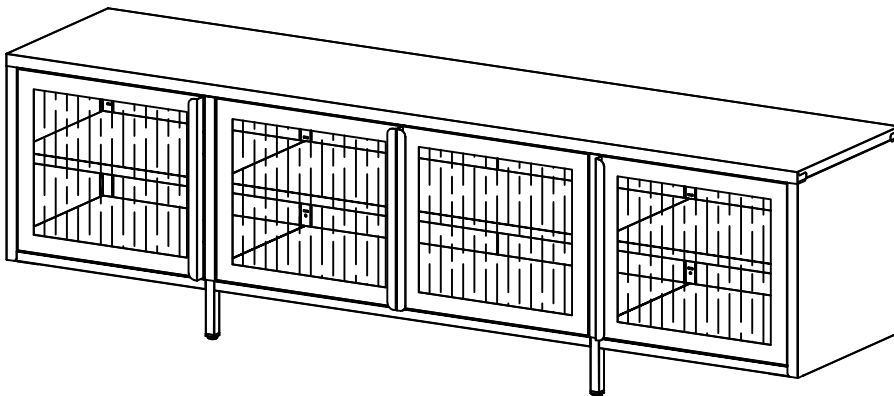

gaps between the doors and frame may appear if it's not level to the floor.
Adjusting the legs will fix this.

